

CTS-Rx-PT1000 TEMPERATURE SENSOR

for room installation, Pt1000 sensor element



TECHNICAL DATA

Sensor element:	1000 Ohm at 0°C DIN EN 60751, class B
Temperature range:	-30 to 70°C
Casing materials:	ABS
Colour:	White, black and grey
Weight:	51 g
Protection class:	IP20

DIMENSIONS

(mm)

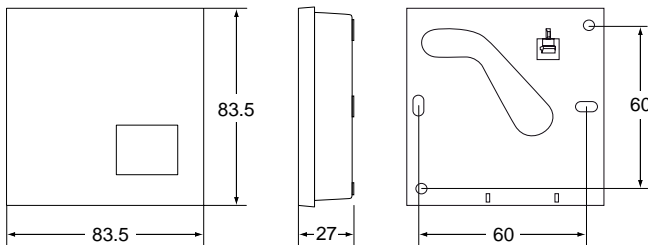

OPENING THE COVER

The cover has a snap-on/off function which ensures easy removal using a screwdriver.

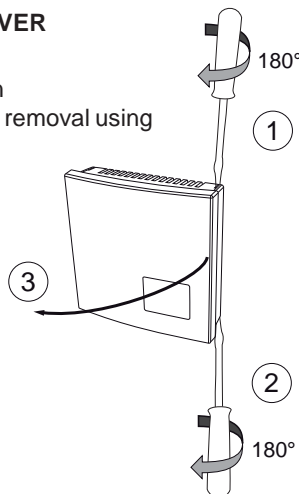

PROPERTIES

- Pt1000 sensor element
- Simple installation
- Available in colours; white, black and grey
- Snap-on/off function on cover

USE

CTS-R temperature sensor is used for measuring air temperatures.

INSTALLATION

CTS-R temperature sensor is fitted with the bars vertical to ensure the throughflow of air. The sensor is fitted approximately 10 mm from any doorframe or wall to ensure easy access to the cover.

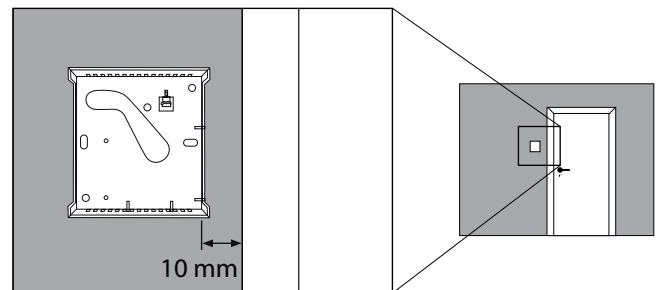

The housing has a cable entry on the backside for connection cables coming from a wall terminal box.

If the connection cable is installed on the outside of the wall, there are bosses on the backside of the housing that makes a space of approx. 1 mm between the wall and the housing for the conductors. When the conductors are thicker than 1 mm, use the space between the ventilation bars as cable entry. If needed, remove one bar for more space.

REMOVAL OF PRINTED CIRCUIT CARD

Detach the sensor's printed circuit card by carefully loosening the lock catches.

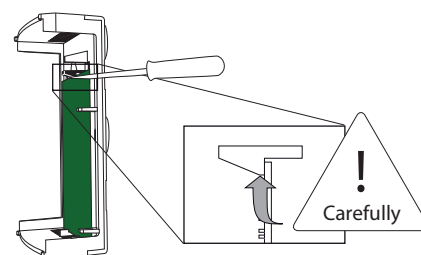

ORDERING EXAMPLE

Item code	Designation
CTS-RW-PT1000	Room sensor, white
CTS-RB-PT1000	Room sensor, black
CTS-RG-PT1000	Room sensor, grey